

TO-263

- $V_{CE} = 650V$
- $I_C = 10A @ V_{CE} = 100V$
- $V_{CE(sat)} = 1.8V$

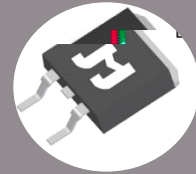

- High ruggedness performance
- 10 μ s short circuit capability
- Positive $V_{CE(sat)}$ temperature coefficient
- High efficiency for motor control
- Excellent current sharing in parallel operation
- RoHS compliant
- HBM 2000V

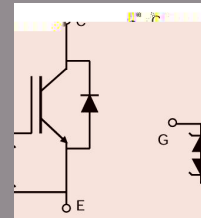

- Home appliances
- Motor drives

Type	Marking	Package	Packaging method
JJT10N65SCD	T1065SCD	TO-263	Tape and reel



CES	Collector-emitter voltage	650	V
GES	Gate-emitter voltage	±20	V
	Continuous collector current ($\rho_c=25$)	20	A
C	Continuous collector current ($\rho_c=100$)	10	A
CM	Pulsed collector current,		



V_{CES}	Collector-emitter breakdown voltage	$V_{GE}=0V, I_C=250\mu A$	650	-	-	V
I_{CES}	Collector-emitter leakage current	$V_{CE}=650V, V_{GE}=0V$	-	-	50	μA



($v_j=25$ unless otherwise specified)

F	Diode forward voltage	$I_F=10A$	-	1.4	-	V
		$I_F=10A, v_j=175$	-	1.2	-	V
t_{rr}	Diode reverse recovery time	$V_R=400V$ $I_F=10A$ $d I_F/d t = -750A/\mu s$	-	57	-	ns
I_{rrm}	Diode peak reverse recovery current		-	12	-	A
Q_{rr}	Diode reverse recovery charge		-	411	-	nC
t_{rr}	Diode reverse recovery time	$V_R=400V$ $I_F=10A$ $d I_F/d t = -750A/\mu s$ $v_j=175$	-	122	-	ns
I_{rrm}	Diode peak reverse recovery current		-	14	-	A
Q_{rr}	Diode reverse recovery charge		-	741	-	nC



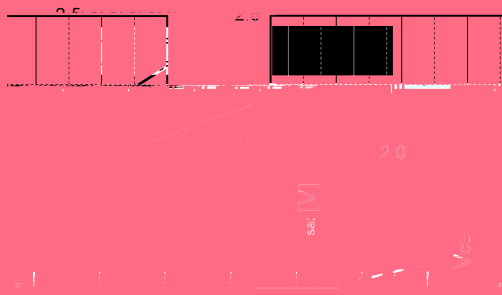

Fig 7. Typical C_{ESat} as a function of v_j

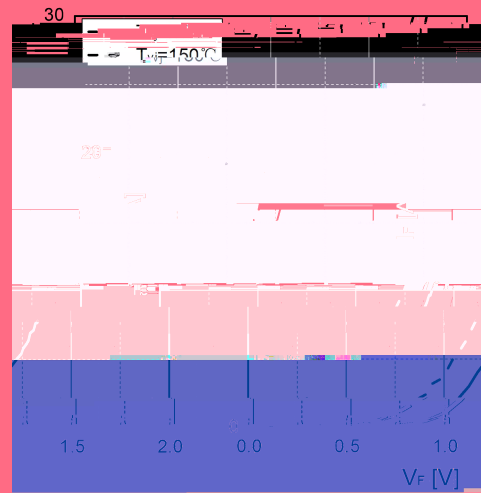

Fig 8. Typical F as a function of V_F

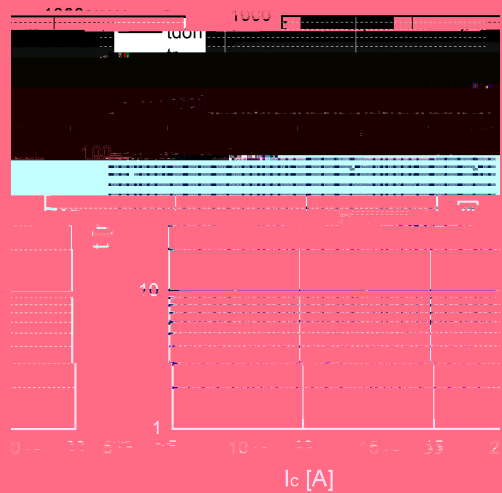

Fig 9. Typical switching time as a function of I_c

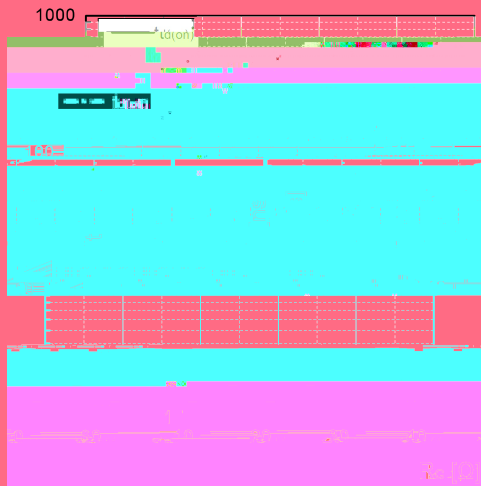

Fig 10. Typical switching times as a function of I_G

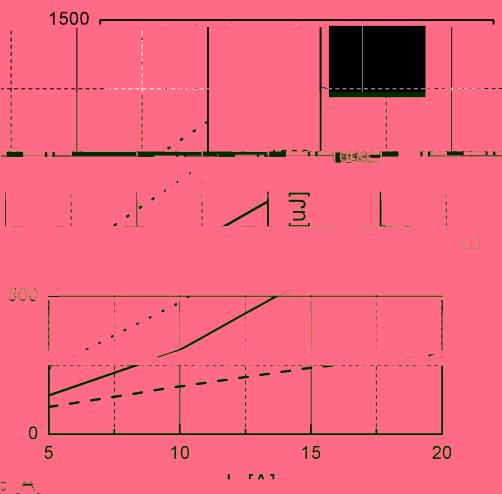

Fig 11. Typical switching energy losses as a function of I_c

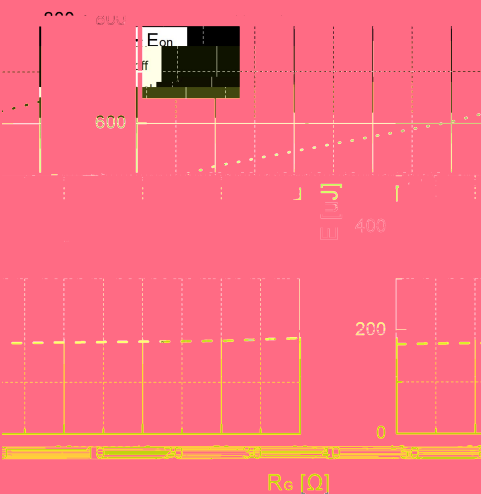

Fig 12. Typical switching energy losses as a function of I_G



All product information is copyrighted and subject to legal disclaimers.



TO-263

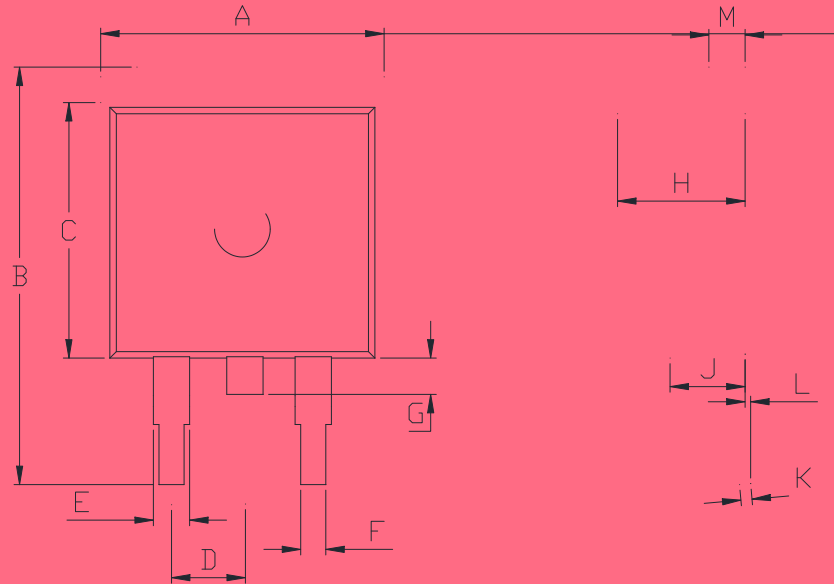

Ref.	Dimensions					
	Millimeters			Inches		
	Min.	Typ.	Max.	Min.	Typ.	Max.
A	9.90	-	10.20	0.390	-	0.402
B	14.70	-	15.80	0.579	-	0.622
C	9.4	-	9.6	0.37	-	0.378
D	-	2.54	-	-	0.100	-
E	1.20	-	1.40	0.047	-	0.055
F	0.75	-	0.85	0.029	-	0.033
G	-	-	1.75	-	-	0.069
H	4.40	-	4.70	0.173	-	0.185
J	2.30	-	2.70	0.091	-	0.106
K	0.38	-	0.55	0.015	-	0.022
L	0	0.10	0.25	0	0.004	0.010
M	1.25	-	1.35	0.049	-	0.053

Date	Rev	
2024-02-06	Rev 1.0	Initial Rth graph
2025-02-06	Rev 1.1	Add Rth graph



PLEASE NOTE - Jiangsu JieJie Microelectronics Co., Ltd ("JJM") reserves the right to amend, correct, modify, cancel or remove the product and/or this document at any time without prior notice. If you intend to purchase this product, please obtain the latest information available before placing your order. The sale of JJM products is governed by JJM's prevailing terms and conditions at the time of purchase and, purchasers are solely responsible.